

1 Check accessories for completeness:

Scope of delivery:

- A. Assembly and operating instructions
- B. Screw cover caps
- C. Two-way key bit
- D. 2 pcs. fasteners
- E. Fixing screws (4.5 x 50)
- Fixing screws (4.5 x 60)
- F. Hinge accessories (Hinge pin + hinge caps)

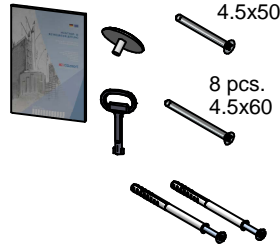

Required tools:

- Spirit level
- Masonry drill \varnothing 10
- Cordless screwdriver/ Cordless drill
- Hammer
- Pliers

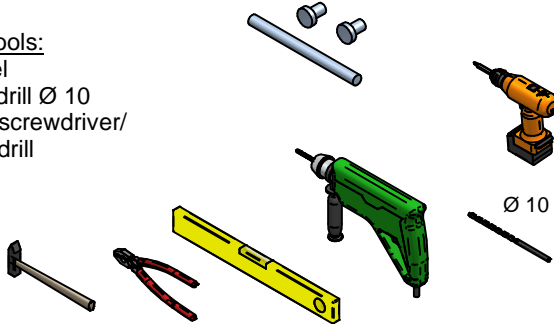

2 Set up base module

Level the base module on a clean, solid, non-flammable floor*.

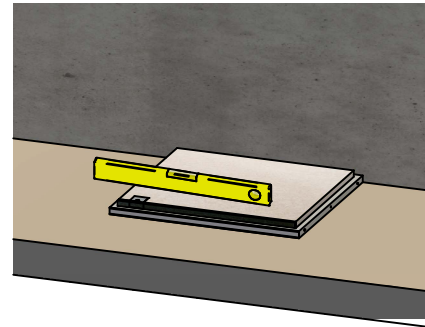

* if the floor is too uneven, if necessary, level the floor before starting the assembly

3 Place the rear panel

Place the rear panel in the existing openings in the base module using metal pins (Fig. 1).

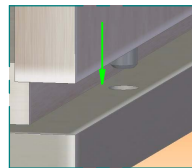
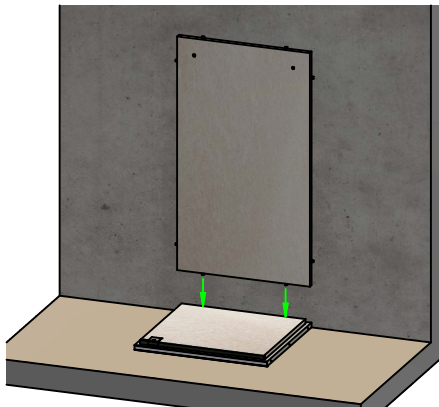

Fig. 1



Caution!
Do not pry!
Risk of bursting!

4 Place side modules

Place the side module in the existing openings in the rear panel using metal pins (Fig. 2).

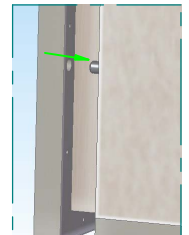
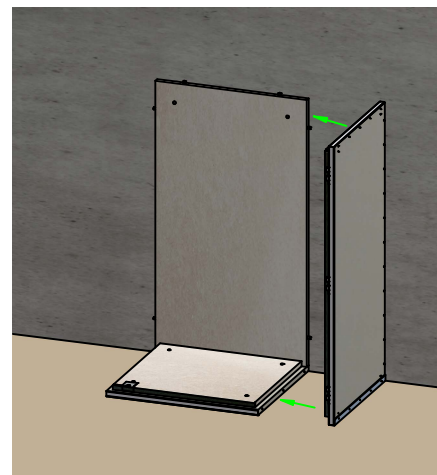

Fig. 2



Caution!
Do not pry!
Risk of bursting!

5 Screw together side modules

Screw the side module (with supplied screws) into the rear panel + base module. Repeat points 4 + 5 with opposite side module.

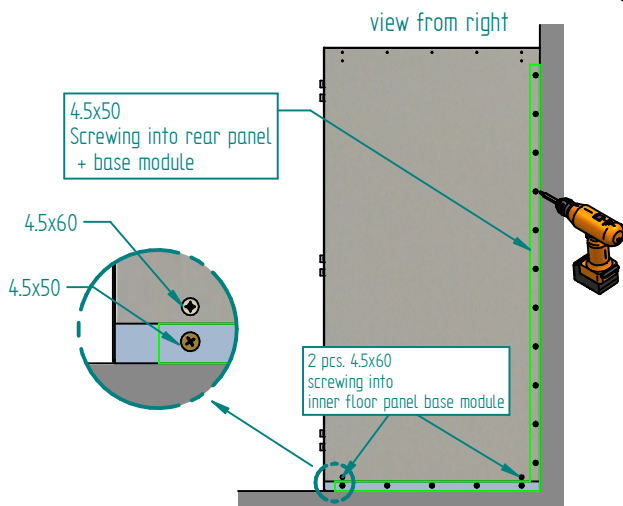
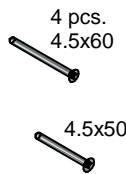

6 Place cover module

Place the cover module in the existing openings in the rear panel using metal pins (Fig. 3).

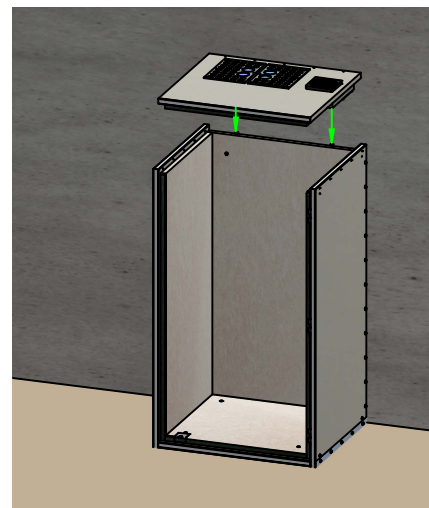

Fig. 3

7 Fastening cover module

Screw the cover module to the side modules (Fig. 4).
Screw the cover module to the rear panel from above using 4.5x50 (Fig. 5)

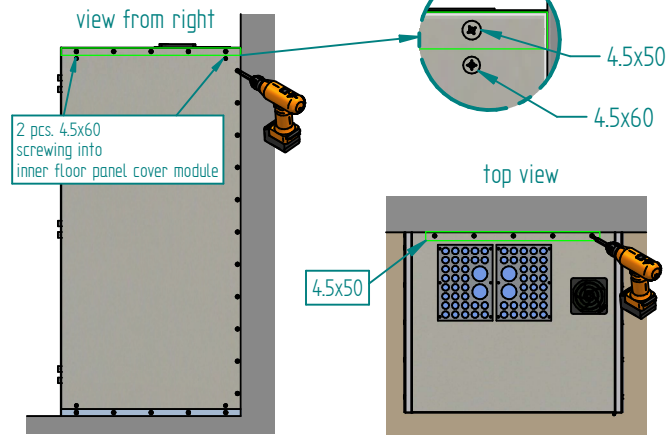

Fig. 4

Fig. 5

4 pcs.
4.5x60 4.5x50

8 Insert closure

per Scharnier:
-1x hinge pin
-2x hinge caps

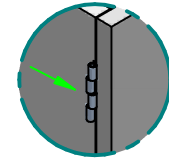
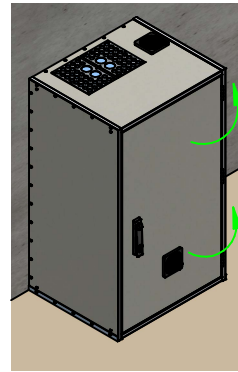

-insert the hinge leaf of the closure module into the hinge leaf of the side module

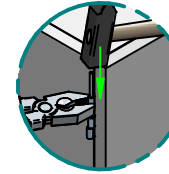

-insert hinge pin, if hinge leaves do not align--> slighty press together with pliers

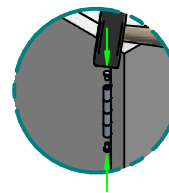

-put 2x hinge cover caps on top and bottom of the hinge (use a hammer if necessary)

9 Wall mounting (if installed in front of lightweight partition wall, follow step ⑩ page 3 instead step ⑨)

Before drilling, check that the enclosure is vertically aligned + gap dimensions are even
--> Check diagonal dimension

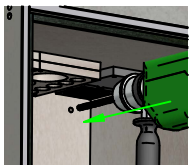

- drill through pre-drilled holes in rear panel (drilling depth=dowel length+10mm)

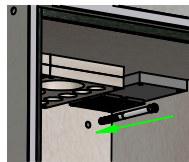

- remove drilling dust from drilling holes
- drive in dowel+screw by means of push-through installation (use a hammer if necessary)



- tighten the screw firmly using a cordless screwdriver (Torx 40)

Torx
T40



Caution!
Do not overtighten!
Do not sink the screw head into the material!

10 Check closure for ease of movement

It must be possible to open and close the enclosure easily.
(if necessary, open and close the swivel lever several times)

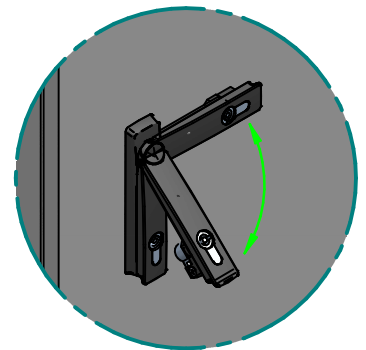
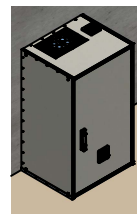
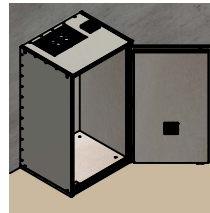

11 Attach the cover caps

Fit the cover caps onto the screws.
(use a hammer if necessary)

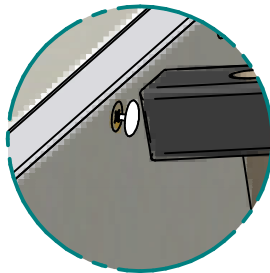
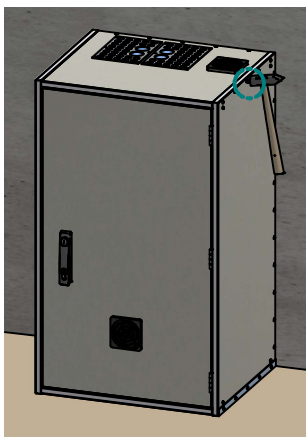

12 Final check

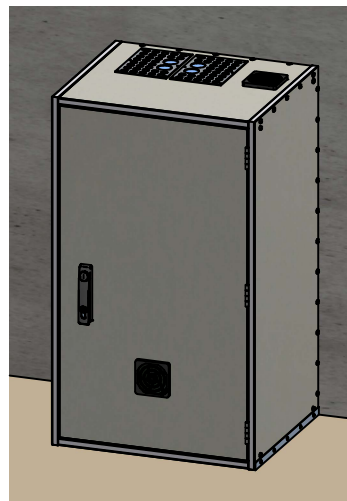

13 Floor mounting when installed in front of a lightweight partition wall

Before drilling, check that the enclosure is vertically aligned
 + gap dimensions are even
 --> Check diagonal dimension

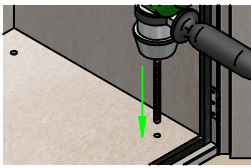

- drill through pre-drilled holes of Base Module (drilling depth=dowel length+10mm)

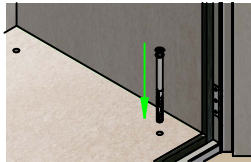

- remove drilling dust from drilling holes
 - drive in dowel+screw by means of push-through installation (use a hammer if necessary)

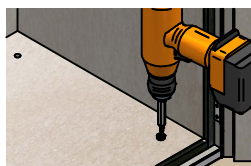

- tighten the screw firmly using a cordless screwdriver (Torx 40)



Caution!
 Do not overtighten!
 Do not sink the screw head into the material!

Then follow steps 10, 11 and 12 on page 2.

for further information on the operation and installation of our products, please refer to our assembly and operating instructions and the QR code to scan



Assembly and Operating Instructions

Please print and keep it in the enclosure!